

**Self-reversing tapping attachments with high-speed reverse, pre-selective torque control and adjustment for shallow depth tapping**

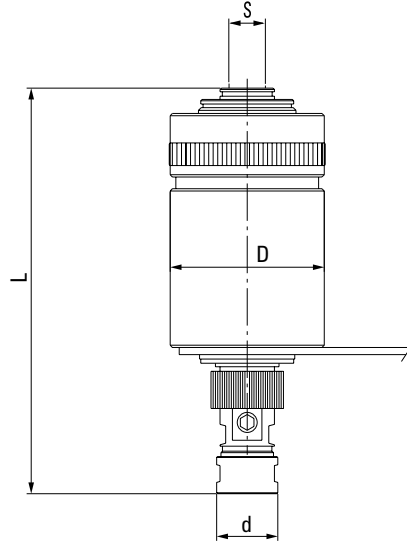

- adjustable depth control for shallow blind hole
- easy handling, compact design
- less tap breakage due to pre-selective torque control
- easy adaption with multiple interchangeable arbors
- reduced cycle time through increased 1.75:1 reverse speed
- only 2 Rubber Flex collets per model required.

**How to Order**

Please select the tapping attachment (A) and arbor (C) to fit your application. Choose an arbor to fit the thread or taper mount of the tapping attachment, with the Morse Taper, R8 or straight shank to fit your machine. Please order rubber flex collets and torque bars separately .

**Dimensions**

Model	D	d	Self-feed	Weight kg
30TC/DC	48	19	1.5-3.5	0.5
50TC/DC	70	27	2-6	1.2
70TC/DC	76	36	3-9	2.3

(A) Model	Capacity (steel)	Collets Rubber Flex Order Code (Shank Ø)	Mounts S		Order code	L	Max. RPM
			Taper mounts	Thread. mounts			
30TC/DC	M1.4-M7 #0 - 1/4"	21600 (2.5-4.5) 21700 (4.5-6.5)	JT6	5/16"-24* 3/8"-24 1/2"-20 5/8"-16*	14306	122	2000
			B12		14312		
			B16		14316		
			JT33		14333	113	
					14331		
					14337		
50TC/DC	M3-M12 #6 - 1/2"	22100 (3.5-6.5) 22200 (6.4-10.0)	JT6	3/8"-24 1/2"-20 5/8"-16*	14506	169	1500
			B16		14516		
			JT33		14533		
					14537	191	
					14550		
					14562		
70TC/DC	M5-M18 #10 - 5/8"	24100 (4.5-10) 24500 (9.0-15.0)	JT3	1/2"-20 5/8"-16* 7/8"-20	14703	191	1200
			B18		14718		
					14750		
					14762		
					14762		
					14787		

**Note:** When using Roll Form Taps the tool's tapping capacity must be reduced by 25 %.  
 \* These special thread mounts are only for Burgmaster machines.  
 All dimensions are shown in mm. 25.4mm = 1"

**RF Rubber Flex Collets**

Tapping Head Capacity	RF Collet Order code	Clamping Capacity (mm)	Tap Capacity Metric Sizes (DIN 371, 374)	Tap Capacity Inch Sizes
M1.4-M7 #0-1/4"	21600	2.5-4.5	M1.6-M4	#0-#8
	21700	4.5-6.5	M4-M6	#10-1/4"
M3-M12 #6-1/2"	22100	3.5-6.5	M3-M6	#0-1/4"
	22200	6.5-6.5	M7-M12	5/16"-1/2"
M5-M18 #10-3/4"	24100	4.5-10.0	M4-M12	#10-1/2"
	24500	9.0-15.0	M10-M18	1/2"-3/4"

